

LoRa WAN Smart Water Meter

Available size : DN15~DN25(1/2"~1")

Best measuring performance for cold potable water. Great choice for commercial building, submetering and smart building.



PN10(PN16) based on request

Designed for horizontal installation

Innovative Magnet-Free measuring technology

Direct reading LCD register, protected from condensation

Build-in 10 years battery lifespan

ISO certified class C flow performance

Value added smart functions such as totalizer, flow rate, flow directions(forward/reverse), data-logging, leak detection, tamper alarms and MNF functions for DMA applications

▼ Specifications (LoRa communications)

Type	Integrated
Communication	LoRa module
Frequency	AS923, EU868 (options)
Emissive Power	Max. 20Db
Communication Interval	1~1440 minutes
Power	Build-in battery; DC 3.6V
Data Transmission	Forward / Back flow; Totalizer; Smart Functions (LNOUHB day); Configurable
Antenna	Flexible Antenna
Waterproof	IP 68
Communication Distance	Open Space: 10KM
Battery Life-span	10 years

The consumption of the battery depends on the communications frequency.
8 years battery lifespan is configured based on daily communications.

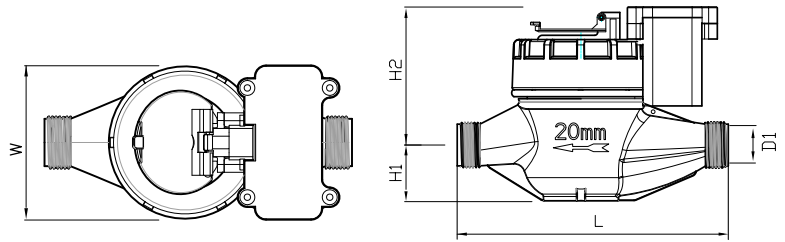

Unit:mm

Dimensional

LoRa-Smart Electronic Water Meter

Model	Diameter (D) mm(inch)	Length max (L)	Max Width (W±2)	From Bottom to Aperature (H1)	From Head to Aperature (H2±2)	Thread Diameter (D1±0.3)	Approx. Weight (kg)	Threads Numbers Avg.25.4mm
PH15	15(½")	165	95.5	42.0	102.0	26.0	0.88	11
PH20	20(¾")	195	95.0	40.3	103.7	32.9	0.95	11
PH25	25(1")	225	99.5	46.5	108.5	41.0	1.15	11

Technical Data

ISO 4064 : 1993 (Class C)

Flow	Units	DN 15	DN 20	DN 25
Q1	m ³ /h	0.0150	0.0250	0.0350
Q2	m ³ /h	0.0225	0.0375	0.0525
Q3	m ³ /h	1.5	2.5	3.5
Q4	m ³ /h	3	5	7

Communication Network

